

## Basic Components

### Deck

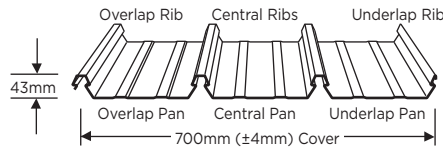

### Translucent Sheeting 4 Rib

Design Reg No. 123185

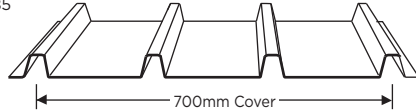

Free underlap sheet edges, such as may be encountered when using translucent sheeting, may need additional support. Use a 40mm x 40mm x 1.0mm trim angle beneath the underlap and screwed to the purlins if spans exceed 1500mm for 0.42bmt, and 2000mm for 0.48bmt.

### Translucent Sheeting 5 Rib

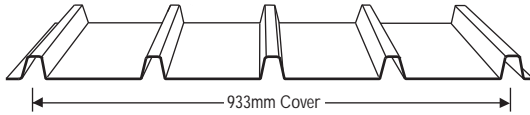

Fix in accordance with manufacturer's instructions.

### Clip

- Pre-loaded with screws (metal fixing only)
- Plain - no screws

Extended rail compresses insulation beyond deck edge.  
The four locking points equally share the load around the fastener.

Continuous rail to depress insulation and maintain deck shape and rib centres.

The full length clips locate ribs, lock solidly and correctly into place while compressing insulation across the full width of the deck.

Optional preloaded fasteners give even faster, easier installation.

Readily available hexagon headed screws are bigger, stronger and easier to install, reducing time, cost and wastage.

Design Reg No. 121366

### Fasteners

Please use recommended fasteners to ensure maximum deck performance. Note: Performance data based on steel purlins 1.5mm thick or greater.

 • for metal No.12 x 30mm Hex. head

 • for timber No.12 x 50mm Hex. head type 17

## Features

- Wider Cover – fewer sheets and quicker installation
- Deeper Ribs – stronger and stiffer with better water carrying capacity
- Full Length Clips – to locate ribs and compress insulation
- Hex Head Screws – bigger, stronger and easier to install
- Improved Wind Load Resistance – improved security with lower purlin costs
- Automatic Bird Proofing – built in accessory with no need for extra components
- Fully tested for cyclonic conditions
- Distinctive ‘snap’ when deck is clipped on

For details refer to the **Stramit Speed Deck Ultra®** technical manual.

**Stramit Speed Deck Ultra®** decking may also be used for domestic applications. Please note, one consequence of the clip/sheeting connection in a concealed fixed system is the friction between the deck and the clip. All steel roofs experience movement due to thermal expansion and contraction when there are temperature differences, and this longitudinal movement causes the sheet to rub against the clips, sometimes causing noise.

This movement is not constant, it occurs in stages, and each movement can cause a sound as the sheeting moves against the clip. Where the clips are spaced far apart such as 1500mm or more, some of this movement is taken by the bowing of the sheeting rather than the slip on the clips, thereby reducing the noise impact.

In residential situations, however, the clips are often spaced much more closely, which increases the propensity for friction and hence noise.

The use of insulation blanket can alleviate the impact of some of the noise.

**IMPORTANT NOTICE:** The information contained within this brochure is for general use and information only. Before application in a particular situation, Stramit recommends that you obtain appropriate independent qualified expert advice confirming the suitability of product(s) and information in question for the application proposed. While Stramit accepts its legal obligations, be aware however that to the extent permitted by law, Stramit® disclaims all liability (including liability for negligence) for all loss and damage resulting from the use of the information provided in this brochure.

™ and ® trademarks of Stramit Corporation Pty Limited. ABN 57 005 010 195 trading as Stramit Building Products. Part of Fletcher Building Group. The document replaces all previous issues. Please destroy, or clearly mark as superseded, all previous issues. JUN21

**Stramit®**  
CONSIDER IT DONE

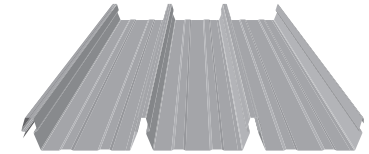

**STRAMIT  
SPEED DECK  
ULTRA®**

CONCEALED FIXED DECKING

**1-2-3**

installation procedure

## Basic Installation Procedure

Stramit® recommends that all relevant OH&S and other safety regulations be followed during the installation of the roof system.

### If insulation blanket is to be installed:

- ensure safety mesh, and spacer if required, are installed and fixed according to OH&S regulations and suppliers' guidelines.
- step on clip rail to ensure it is level when screwing clips

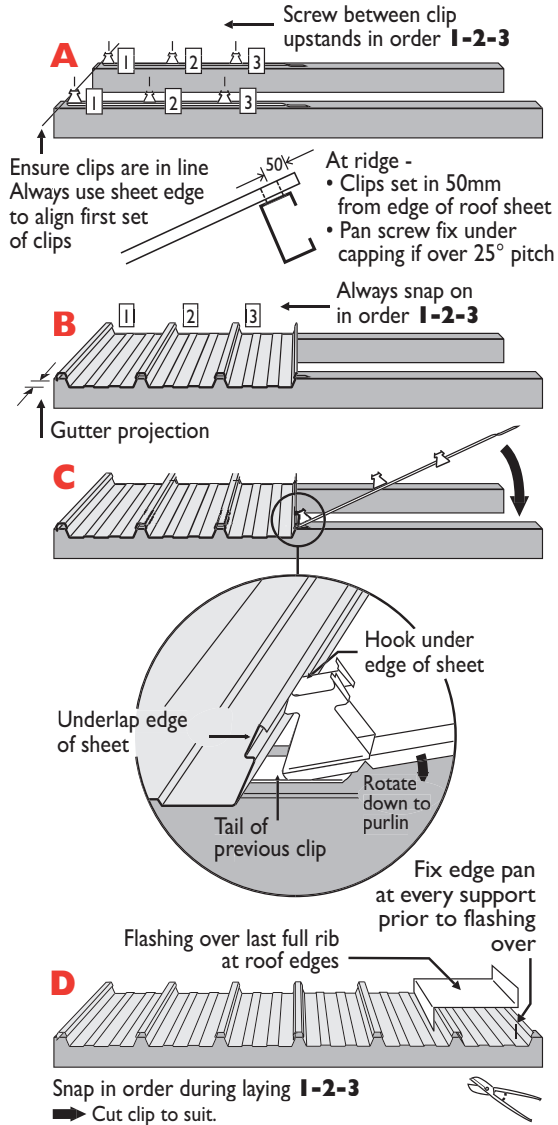

For full installation instructions please refer to the **Stramit Speed Deck Ultra®** technical manual.

**Do** ✓

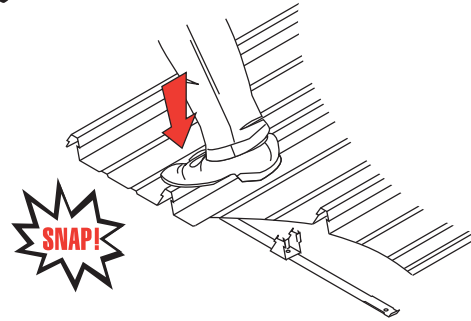

**Do** snap ribs onto clips in the correct order **1-2-3**.

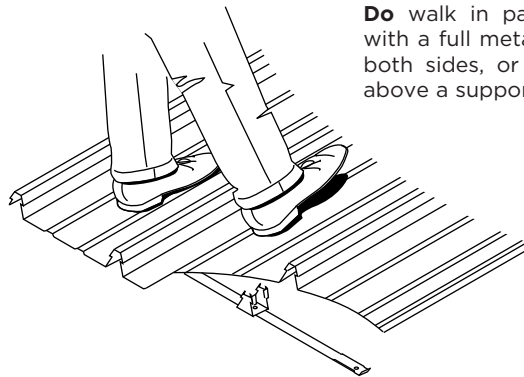

**Do** walk in pans only with a full metal rib on both sides, or directly above a support.

**Do** ensure next clip hole alignment at underlap

- clip must be hooked beneath underlap
- screw must go through both holes

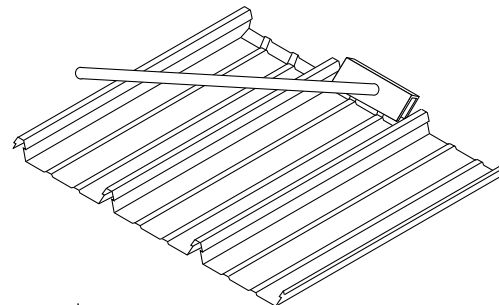

**Do** turn-ups and turn-downs after sheet laying

**Don't** ✗

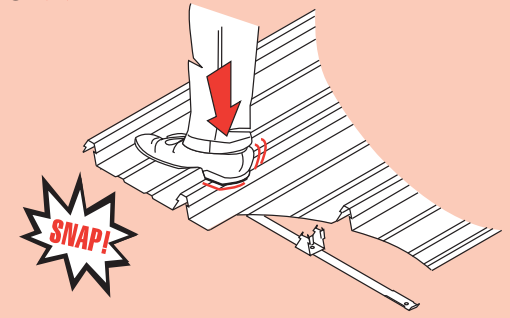

**Don't** use excessive force. Light pressure only.

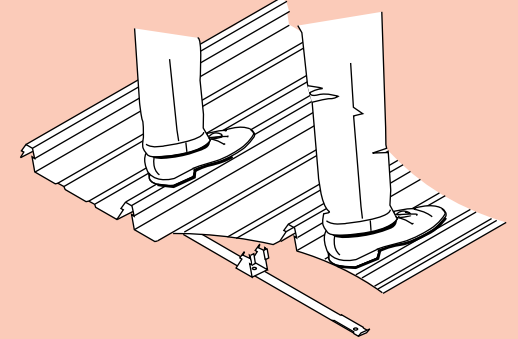

**Don't** walk on ribs except over a support.

**Don't** walk in underlap pan when unsupported by either another metal sheet or a support.



**Don't** use wafer head screws.



**Don't** use lead pencils.