

POP UP PENETRATION™

LYSAGHT

DIFFUSER KIT INSTALLATION GUIDE FOR EXISTING
DRY PAN / TRAY FLASHING PENETRATION SYSTEMS



POP UP PENETRATION™ SYSTEM

The patented Pop Up Penetration™ system facilitates the even flow of rainwater around roof penetrations such as chimneys, pipes, skylights, exhaust fans, vents and air conditioning units. Used as a replacement for traditional dry pan flashing systems the Pop Up Penetration system's unique design minimises the impact of penetrations on the ability of long run roofing to carry water away evenly and efficiently.

POP UP PENETRATION™ DIFFUSER KIT

For many existing buildings dry pan flashing systems are installed which may not be economical to replace. Pop up Penetration™ Diffuser Kits are both fast and easy to install.

The Pop Up Penetration™ Diffuser Kit has been designed to enable retrofitting to existing dry pan flashings hereby delivering the hydraulic benefits of the Pop Up Penetration™ system without the need to remove the existing flashing.

Available in a range of quality materials, finishes and colours to complement any roof, the innovative Pop Up Penetration™ Diffuser Kit also easily accommodates multiple roof penetrations ensuring each penetration re-diverts its own water correctly and does not affect roof run performance.*

Pop Up Penetration™ Diffuser Kit's are available in five convenient sizes covering roof penetrations sizes ranging from 100mm to 3300mm.

Table 1

Kit Size Cutout Dimensions	
Kit No	Max width of penetration in any direction (mm)
1	UP TO 570
2	571 - 1100
3	1101 - 1700
4	1701 - 2400
5	2401 - 3300

* For a maximum of 240m² of "upstream" roof. Please contact your local Lysaght Branch for details.

KIT COMPONENTS

Each Pop up Penetration™ Diffuser Kit contains the following components:

Vertical side flashings

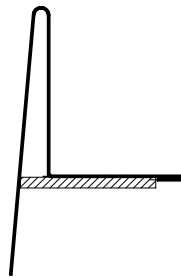

Front diffuser flashing

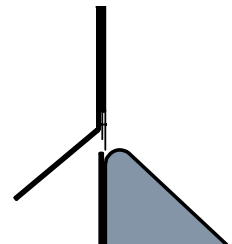

Vertical side 40 x 3.2 self adhesive closed cell foam

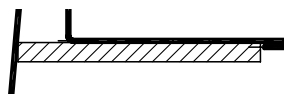

Infill strips to suit the roofing profile



Side diffusers

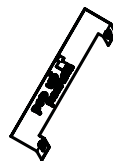

Front diffusers towers

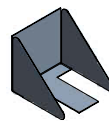

M6 x 25mm roof ZIPS



INSTALLATION

To ensure optimum results from the Pop Up Penetration™ Diffuser Kit, the following steps must be observed.

WHAT YOU WILL NEED:

- Snips
- Silicone Gun + 1 tube 100% natural cure silicone (Grey for ZINCALUME® steel, clear for COLORBOND® steel)
- Battery drill + 5/16 socket
- Tape measure
- Lead free pencil
- Folding pliers
- Square

STEP 1:

Install front diffuser towers

Remove the screws / rivets attaching the existing front apron flashing to the roof sheet ribs and install supplied foam infill strips underneath the existing apron flashing. Silicone seal old screw / rivet holes prior to sliding the front diffuser towers under the front apron until it stops, then using a 25mm ZIP screw fix into every rib through the previous holes.

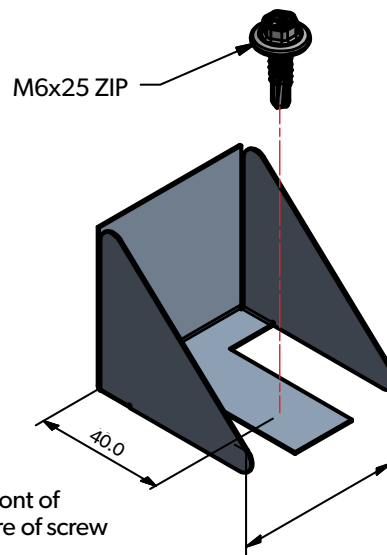
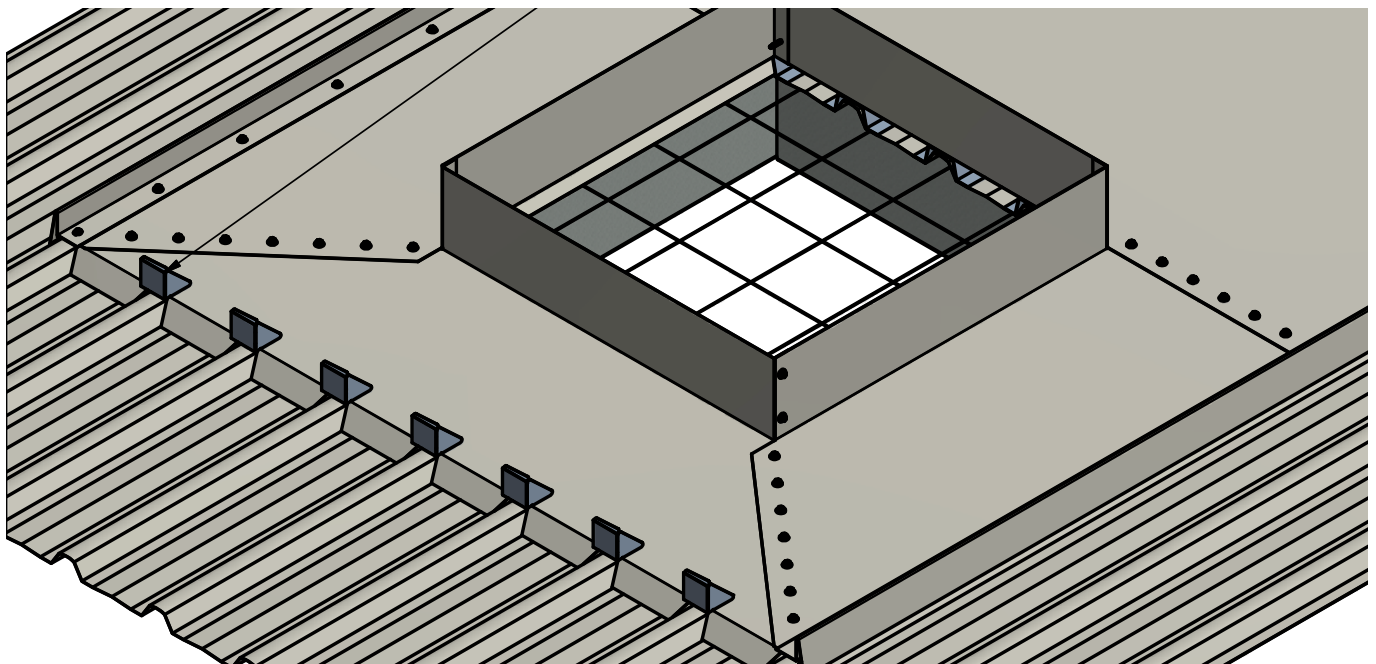

Figure 1.1

Front diffuser tower fixing placement.

Figure 1.2

Front diffuser tower placements.



STEP 2:

Install front diffuser

Trim the front diffuser to the front apron length and notch around the sheeting profile. Slide the diffuser over the front diffuser towers as shown in Figure 2.1. Fix the front diffuser to three of the diffuser towers with rivets.

Figure 2.1

Slide front diffuser over diffuser towers.

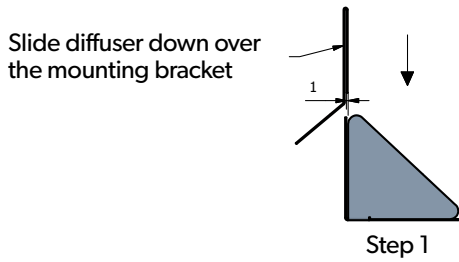
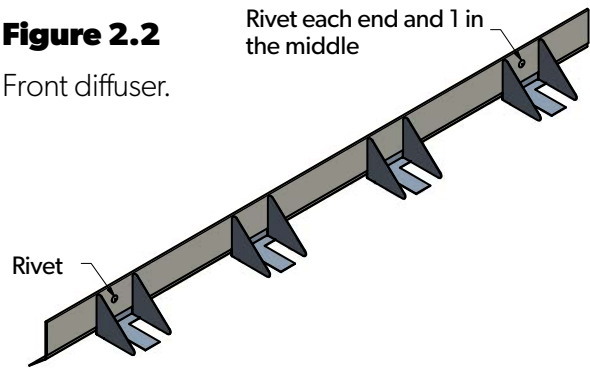

Figure 2.2

Front diffuser.



STEP 3:

Install vertical side flashings

(i) Affix the self-adhesive foam tap to the underside of the vertical side flashing as shown.

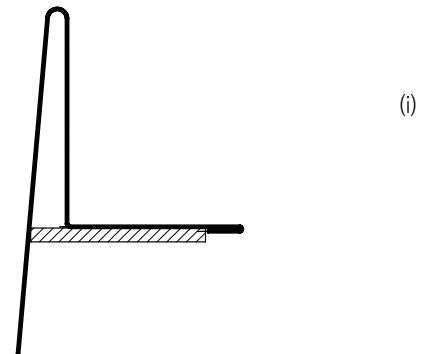

(ii) Then align the vertical side flashing with the front apron flashing of the Penetration.

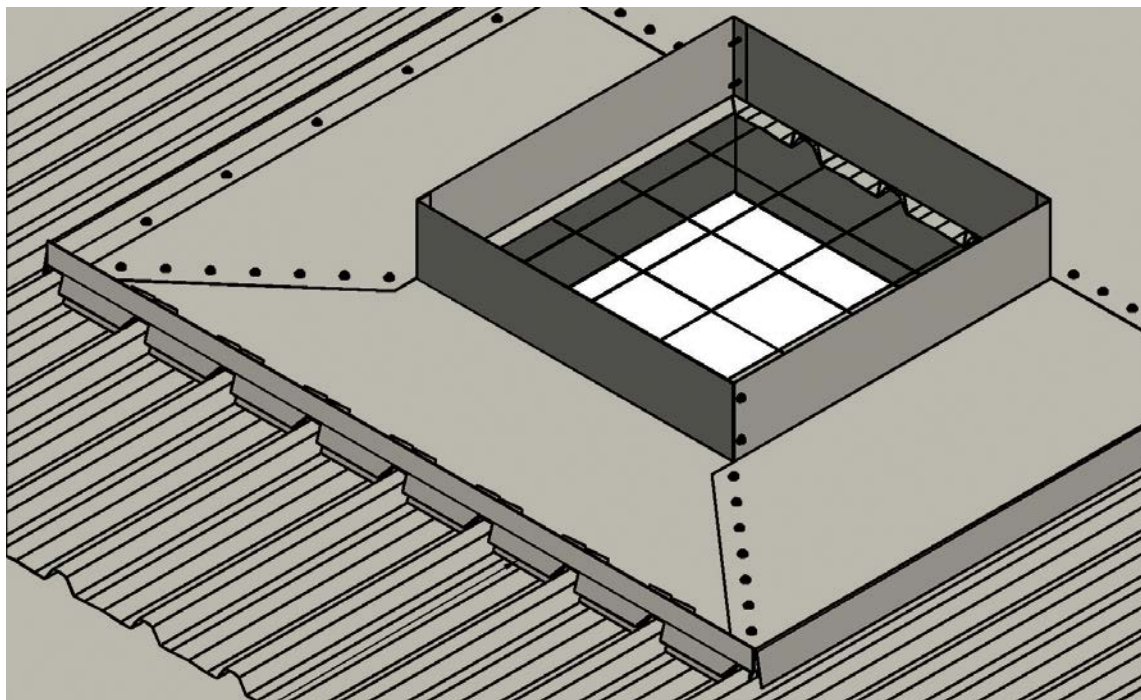

STEP 3:

Continued

(iii) And screw fix it to the side apron flashing with M6 x 25mm roof ZIPS provided at 200mm c/c,

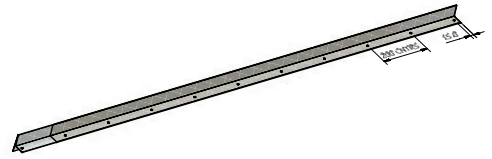

(iii)

LH Vertical Side

STEP 4:

Install side diffuser

Fix the side diffusers approximately 40mm from the vertical sides and approximately 200mm from the front diffuser. Silicone underneath and use 25mm ZIPS to fix into position.

Figure 4.1

Side diffusers.

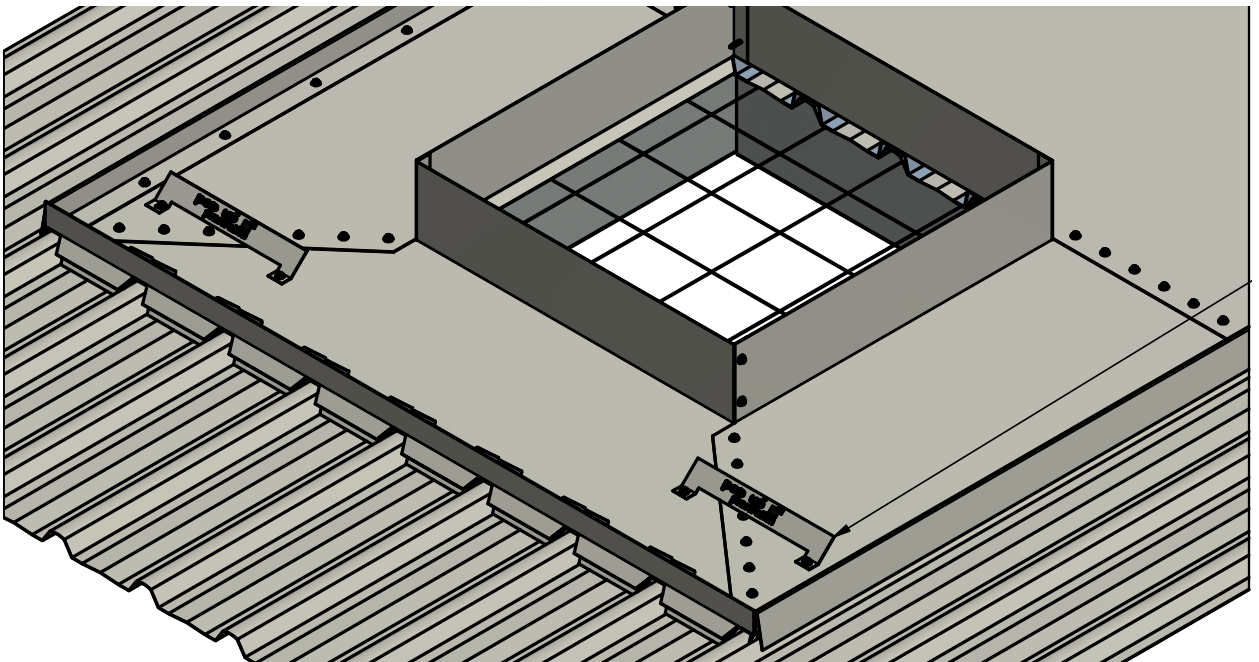

STEP 5:

Clean down and over seal

Remove excess debris and swarf as per manufacturers recommendation and over seal with silicone where necessary.

PRODUCT DESCRIPTIONS

- All descriptions, specifications, illustrations, drawings, data, dimensions and weights contained in this catalogue, all technical literature and websites containing information from Lysaght are approximations only. They are intended by Lysaght to be a general description for information and identification purposes and do not create a sale by description. Lysaght reserves the right at any time to:

- (a) supply Goods with such minor modifications from its drawings and specifications as it sees fit; and
- (b) alter specifications shown in its promotional literature to reflect changes made after the date of such publication.

DISCLAIMER, WARRANTIES AND LIMITATION OF LIABILITY

- This publication is intended to be an aid for all trades and professionals involved with specifying and installing Lysaght products and not to be a substitute for professional judgement.
- Terms and conditions of sale available at local Lysaght sales offices.
- Except to the extent to which liability may not lawfully be excluded or limited, BlueScope Steel Limited will not be under or incur any liability to you for any direct or indirect loss or damage (including, without limitation, consequential loss or damage such as loss of profit or anticipated profit, loss of use, damage to goodwill and loss due to delay) however caused (including, without limitation, breach of contract, negligence and/or breach of statute), which you may suffer or incur in connection with this publication.

FOR YOUR NEAREST SUPPLIER VISIT:

WWW.LYSAGHT.COM

FOR SALES ENQUIRIES CALL 13 30 38

FOR TECHNICAL ENQUIRIES CALL 1800 641 417

© BlueScope Steel Limited 29 August 2019.

® product and colour names are registered trade marks of BlueScope Steel Limited. ™ product and colour names are trade marks of BlueScope Steel Limited ABN 16 000 011 058. The LYSAGHT® range of products is exclusively made by BlueScope Steel Limited trading as Lysaght.



LYT0155 - 08/2019